

REMOVAL AND INSTALLATION OF TRANSFER

Remove and install the parts as shown.

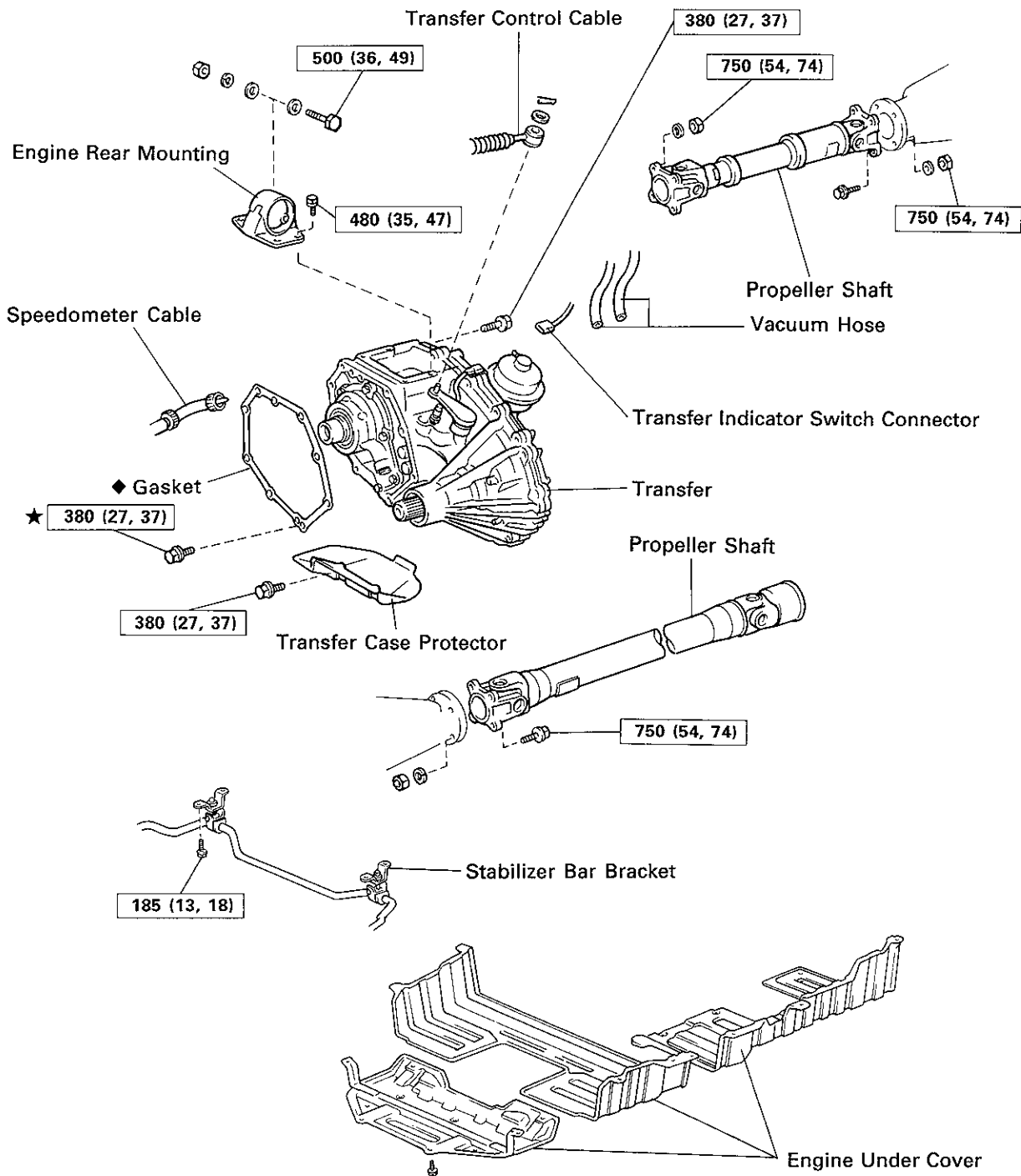

[kg-cm (ft-lb, N-m)] : Specified torque

♦ Non-reusable part

★ Precoated part

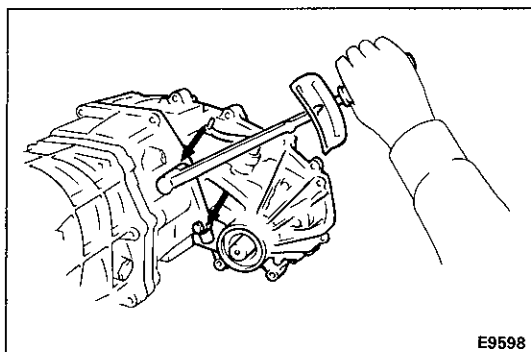
**(MAIN POINT OF INSTALLATION)****1. INSTALL TRANSFER TO TRANSMISSION WITH NEW GASKET**

- (a) Place a new gasket to the transfer adaptor.
- (b) Align the input shaft spline with the transmission output shaft, and push the transfer fully into position.
- (c) Apply sealant to the two front bolt threads.

Sealant: Part No. 08833-00080, THREE BOND 1344, LOCTITE 242 or equivalent.

- (d) Install and torque the bolts.

Torque: 380 kg-cm (27 ft-lb, 37 N·m)

2. FULL TRANSFER WITH OIL

Oil grade: API GL-4 or GL-5

Viscosity: SAE 75W-90

Capacity: 1.2 liters (1.3 US qts, 1.1 Imp. qts)